

Tono B Multi

Low Voltage Track Projectors | IP40 | Class III | Dimmable

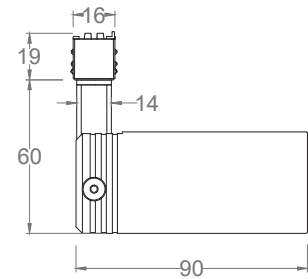
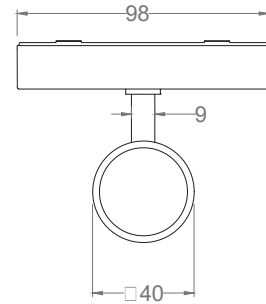

LIGHT SOURCE & OPTIC

Power

3W
7W
10W

Lens

3°/ 10°/ 30°/ 50°

Beam Direction

Adjustable:
Tilting +/- 90°, Rotating +/- 355°,
Symmetrical

Material

PMMA

LED quantity

1

Binning

2 MacAdam step

Color temperature & quality

2200K CRI>80
2700K CRI>80
3000K CRI>80/95
3500K CRI>80
4000K CRI>80
5000K CRI>80

Lifetime

(L90) >60.500 hrs

FIXTURE

Dimensions

Ø 40mm x H 90mm (cylinder)

Material

Aluminium

Body finishes

White (RAL 9003)
Dark Bronze
Black (RAL 9005)

Weight

200gr

Mounting

On Track

Fixing

Track connector

Working temperature

-20° / +40°

ELECTRICAL FEATURES

Power supply

Constant tension 24-48 Vdc
Typical Vf= 3V (3W version)
Typical Vf= 12V

Driver

Remote (not included)

Control

On/off
DALI
Broadcast

Tono B Multi

PHOTOMETRIC DATA (3000K CRI>80)

3W - 3° | UGR 6

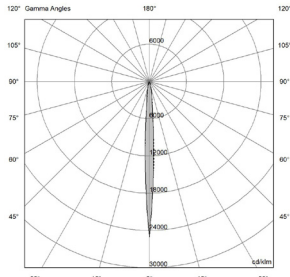

H (m)	D (m)	Eav (lx)
1	0.11	3323
2	0.22	831
3	0.33	369
4	0.44	208
5	0.55	133

Total lumen output
219 lm

Efficacy
73 lm/W

7W - 10° | UGR 8

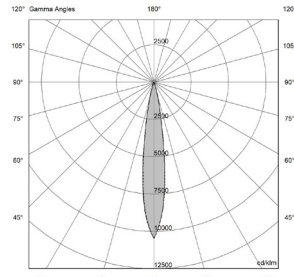

H (m)	D (m)	Eav (lx)
1	0.27	3438
2	0.55	859
3	0.82	382
4	1.10	215
5	1.37	138

Total lumen output
520 lm

Efficacy
74 lm/W

7W - 30° | UGR 11

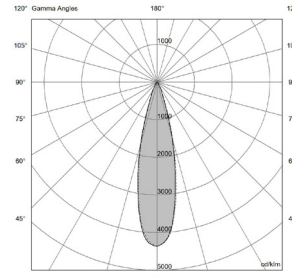

H (m)	D (m)	Eav (lx)
1	0.45	1283
2	0.90	321
3	1.35	143
4	1.81	80
5	2.26	51

Total lumen output
466 lm

Efficacy
66 lm/W

7W - 50° | UGR 13

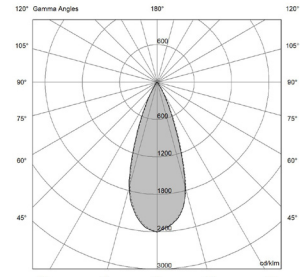

H (m)	D (m)	Eav (lx)
1	0.69	653
2	1.37	163
3	2.06	73
4	2.74	41
5	3.43	26

Total lumen output
442 lm

Efficacy
63 lm/W

10W - 10° | UGR 8

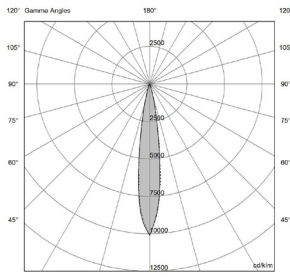

H (m)	D (m)	Eav (lx)
1	0.28	4495
2	0.56	1124
3	0.83	499
4	1.11	281
5	1.39	180

Total lumen output
703 lm

Efficacy
70 lm/W

10W - 30° | UGR 12

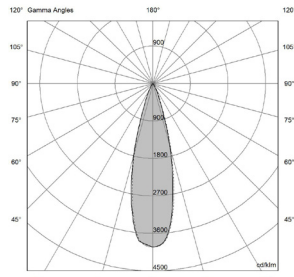

H (m)	D (m)	Eav (lx)
1	0.49	1600
2	0.98	400
3	1.47	178
4	1.96	100
5	2.45	64

Total lumen output
640 lm

Efficacy
64 lm/W

10W - 50° | UGR 14

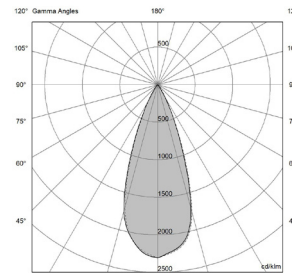

H (m)	D (m)	Eav (lx)
1	0.70	857
2	1.40	214
3	2.10	95
4	2.80	54
5	3.50	34

Total lumen output
599 lm

Efficacy
59 lm/W

Tono B Multi

INSTALLATION ACCESSORIES

Compatible with 24-48Vdc Multi Track:

Surface installation (A01048._0)



Trimless installation (A01402._0)

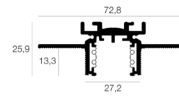
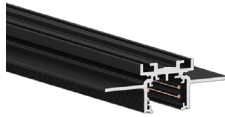

Suspended installation (A01351._0)



SUGGESTED REMOTE DRIVERS

On/Off :

CV70-F-24-N

CV150-F-48-N

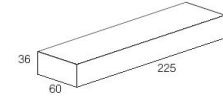

Ø 70

For On/Off and DALI version.
Please consider 1 address for each DALI projector.

Multifunction (DALI 2, 0/1-10V, PUSH):

CV75-DM-24-NI

CV75-DM-48-NI

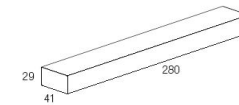

Ø 49

For Broadcast version.
Please consider 1 address for each driver in case of DALI control.

Other options upon request